



Between Turns

Michigan Association of Woodturners

A chapter of the American Association of Woodturners

VOLUME 23, ISSUE 3

MARCH 2011

CONTACT US:

President:

Tom Mogford

810-629-6176

Vice President:

Bill Magee

734-981-6117

Treasurer:

Tim Morris

810-229-7156

Secretary:

Jeff Scott

734-595-0215

Librarian:

Tim Leright

734-595-0223

INSIDE

THIS ISSUE:

| | |
|--------------------------|-----|
| March Meeting | 1 |
| Show-N-Tell Table | 2/3 |
| Bangles | 4/5 |
| Mentors | 6 |
| MAW Newsletter & Website | 6 |
| MAW Sale | 7 |
| Mailbag | 7/8 |

March Meeting...

Gary Smith demonstrated how he turns his Bangles. Gary has turned bangles from a solid piece of wood as well as segmented turning blanks.



Tim Leright discussed a new chainsaw sharpening system that sells for 75.00 for the kit.

Thank you Carol for the cookies.



Tim and Tom describing the sharpening system.

June 11th the club will be hosting Marilyn Campbell. The cost for the one day demo covering her methods for turning wood and epoxy will be covered. Cost is 45.00 and includes a continental breakfast and lunch.

June 12th and 13th will be a hands on demonstration.

Space is limited to 8. Cost is 250.00 for both demo days.

Ohio Valley Woodturning Guild's Turning 2011 registration has opened. Be sure to register soon.

In April John Irvine will demo his egg boxes.

Jeff-



Gary Smith's Bangle.

Upcoming Dates

2011 Meetings :

| | | | |
|--------------------------|--------------|-----------|------------|
| April 3 | May 1 | June 5 | July 10th |
| August 7 Picnic | September 11 | October 9 | November 6 |
| December 4 Holiday Party | | | |

2011 Mentor Weekends :

| | | | |
|-------------|--------------|------------|-------------|
| April 16 | May 14 | June 18 | July 16 |
| August 20 | September 17 | October 15 | November 19 |
| December 17 | | | |

- Meetings are held monthly on the first Sunday of each month from 1:00 p.m. - 3:00 pm at Paul Beemann's 2075 East Rattalee Lake Rd Holly MI 48442.

- Mentor workshops begin at 9:00 am at the same location.

- OVWG 2011 Symposium September 29th.

Show and Tell Table

March was a good month for the show and tell table.

- Gary Smith - Star Vase
- Mike Foydel - Kaleidoscope
- Mike Foydel - Pendants
- Mike Foydel - Goblet
- Carol Butterfield - Walnut Bowl
- Bill Magee - Claro Walnut Burl Beer Bowl
- Bill Magee - Denim Pen and Pencil set
- Jim Scarsella - Green Leaf Box
- Bob Way - Open Segmented Vase
- Bob Way - Ash/Walnut Segmented Vase
- Bill Wollet - Spalted Apple Bowl
- Pete Buccellato - Demo Kaleidoscope for Raffle



Please make sure to sign the show and tell sheet so credit can be given.

Show and Tell Table

March was a good month for the show and tell table.



Please make sure to sign the show and tell sheet so credit can be given.

Bangles (Bracelets)-

Start with a 3.5" blank with the center marked. Use a pipe clamp to measure the desired I.D. (Inside Diameter) of the bangle. Use a scroll chuck as a jam chuck, bringing the tail stock up. 3.5" will fit inside the jaws of the Strong Hold chuck. Turn to 3.5" diameter then mount in the chuck. You do not need to turn a tenon. Measure the diameter of the pipe clamp. Set your compass to half the diameter of the pipe clamp. Use the center hole left by the tail stock and mark the I.D. with the compass. Hollow out the inside of the bangle. Listen for change in sound to tell when you are close to cutting through. Use a scraper to turn the inside of the bangle. Compare the pipe clamp to I.D. to make sure you have the correct size. Close the jaws and cover them with an inner tube. This will protect the bangle from being marred by the jaws. Expand the jaws into the center of the bangle. You need just enough pressure to firmly hold the bangle. Turn the outside of the bangle. Turn to 1/4" to 3/8" thick. Do not turn too thin, you do not want the bangle to break. Sand while on the lathe. Put the inner tube over the bangle and mount in a compression grip on the chuck. Sand the inside. Finish with lacquer. Big Leaf Maple Burl sold the best for Gary.

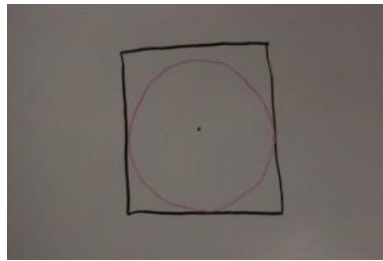

Bangles (Bracelets) continued-

To make a segmented bangle you follow the same turning process after you build your blank.

To make a segmented bangle blank start with a piece of MDF 2.5" square. Use your compass to mark the 2.5" diameter. Use a disc sander to sand one side tangent to the circle. Rotate the blank 90 degrees and place the flat side of the blank against your fence or jig to sand the next side. Continue until your MDF blank has four straight edges that are tangent to the circle you drew with the compass. Glue four strips of the same wood to the four flat sides. When the glue has dried draw the new outside diameter with a compass. Follow the same process as before to sand the 4 points of MDF tangent to the new O.D. (Outside Diameter) circle. These four points will be at 45 degrees from the strips that were just glued on. Glue four new strips of wood to the new straight edges. When the glue has dried draw the new outside diameter with a compass. Continue this process until you reach the desired Outside Diameter.

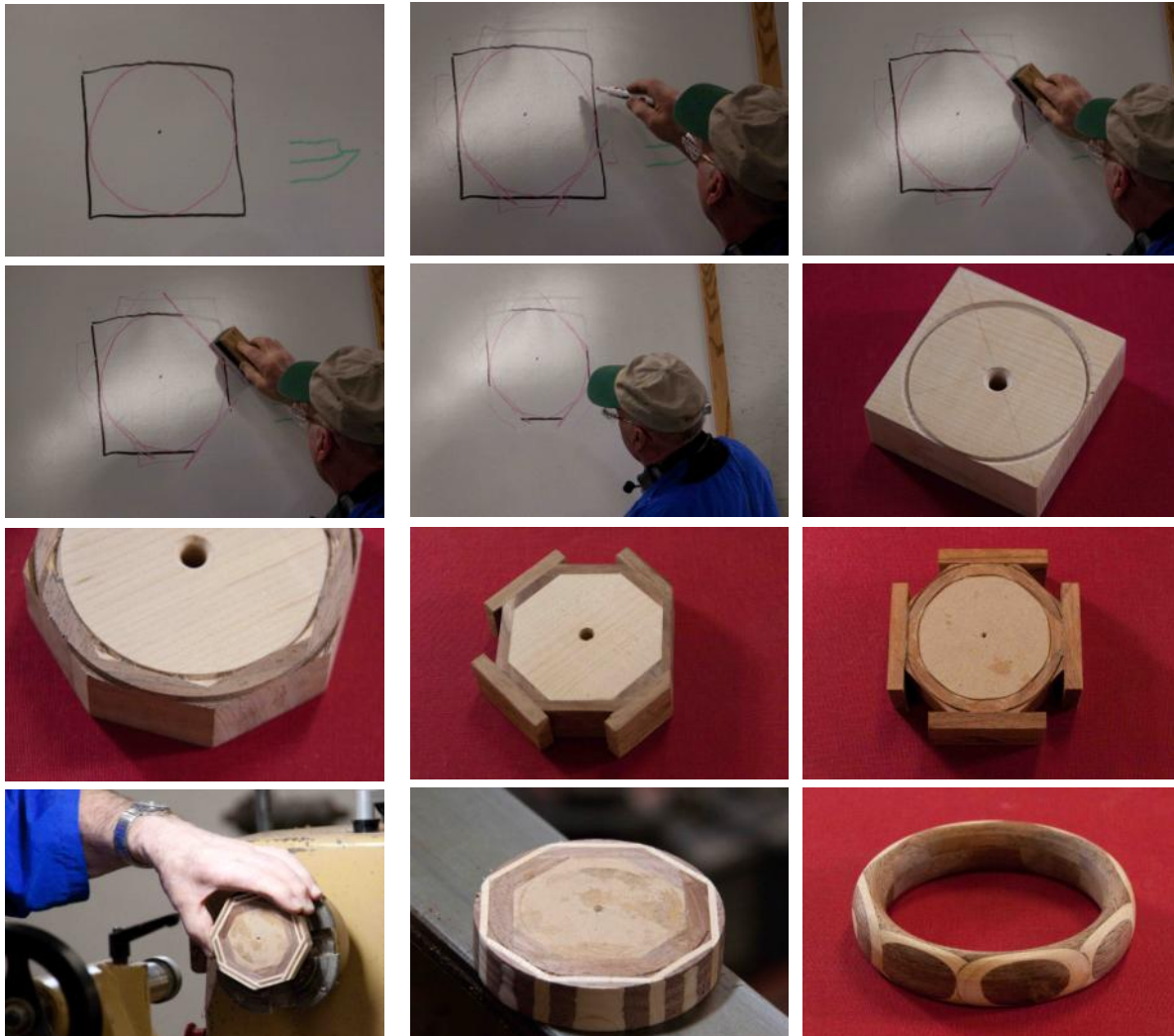

Demonstrators Wanted



Anyone willing to demonstrate at the monthly meeting can contact Tom or Pete to schedule.

We have a number of talented members, so please feel free to share your talents with the club. There are some really interesting projects that members bring in each month for the show and tell table. Many of the club members would be interested in seeing how these projects are created.



Looking to try turning your first bowl?

MAW Mentors

If you would like help getting started in woodturning or help with working out a problem, feel free to call any of the names listed. As always, there is no charge to members of the Michigan Association of Woodturners.

| | |
|--------------------------------|--------------|
| Tom Mogford | 810-629-6176 |
| Pete Buccellato | 248-634-7622 |
| Bill Magee (Pen Turning) | 734-981-6117 |
| Gary Smith | 810-636-7167 |
| Ruby Cler | 519-945-0647 |

The mentor workshop is a good place to start.

Photo's

Photographs for this months "Between-Turns" were provided by Jeff Scott.

If you have digital photo's that you would like to have considered for use in the newsletter, please send them to the editor at:

Jeffatwayne@yahoo.com



Mailbag...

The April M.A.W. meeting will also conduct a huge sale. These items were purchased from member Jerry Seiling, and all proceeds go to the club!

TOOLS: New and used, mostly Robert Sorby. Roughing gouges, scrapers, bowl gouges, spindle gouges, hollowing tools, beading tools, captive ring tools, parting tools, skewers, miniature sets, spare hardwood handles.

WOOD: Exotic and domestic Bowl blanks, large and small spindle blanks, pen blanks (wood and acrylic), bottle stopper blanks.

PEN KITS: .50 cal Bullet pen kits, .30 cal Bullet pen kits, civil war Bullet pen kits, Penn State Classic twist, Woodcraft Parker fountain, Woodcraft Filigree click pens, 7mm & 8mm Rattle Snake Skin blanks, pen display tubes, pen boxes.

MISC: Cork and stainless bottle stopper kits, pewter potpourri lids, confetti lamps and glass chimneys for oil lamps, brass post office box fronts for banks, Yo-Yo forstner bit, coin sized forstner bits, glass tubes for flower vases, hour glasses, various styles peppermills, letter openers, fishing lure kits, book marker kits, dart kits, kaleidoscope kits, clocks, back scratchers, shoehorns candle holders key chains and many more.



The MAW is accepting submissions for the Club Newsletter and Website...

What would you like to read about in the club's newsletter "Between Turns"?

What would you like to see on the club's website <http://www.michiganwoodturner.org>?

Are you willing to write an article for submission please let Jeff know. Possible topics: woodturning, metal turning, wood-working, product reviews, or instructions for your latest project.

With your help we can help make the newsletter and website a better resource for our members.

Send your submissions, suggestions, or requests to Jeff at jeffatwayne@yahoo.com or see me at the meeting.

Mailbag...

WIN A TRIP OF A LIFETIME WITH NOVA

Now NOVA™ is offering you a chance of a lifetime, with a chance for you and a friend to win a place on a WOODTURNING CRUISE along Norways' famed western coast in August 2011, and a host of other prizes of NOVA products, valued at over USD\$15,000!

<http://www.teknatool.com/Competition/winwithnova.htm>



New Tool Racks...

Bill Magee built and installed tool racks for each of the lathes. This will really help keep workstation organized during mentor workshops and demos. Face shields and depth gauges are located at each station. Please make sure that you place all equipment such as live center, spur/steb center, chuck, keys, knock-out bar, etc. back where they belong when you are done. This will help ensure that no equipment is lost.

Thank you Bill.

